

East 1/4 Corner  
Section 1-1-16  
N. 213.030.88  
E. 2,393.062.28

# Plat of Survey

of  
**Lot 43 of Bay View Subdivision,**  
located in the Northwest 1/4 of the Southeast 1/4 of Section 1, Town 1 North,  
Range 16 East, Village of Williams Bay, Walworth County, Wisconsin.

Surveyed for: **Joshua & Jessica Smith**  
50 Highland Street  
Williams Bay, Wisconsin. 53191

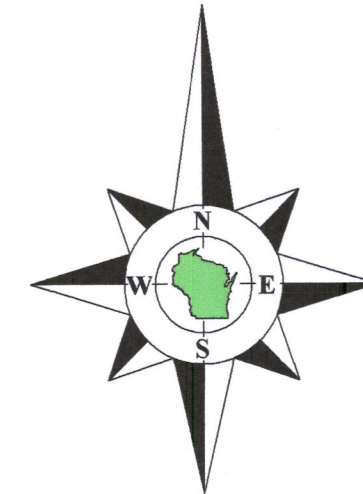
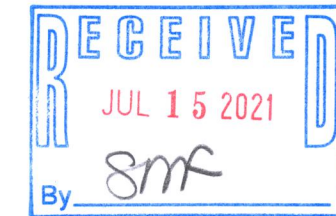

Bearings referenced to the North line of the Southeast 1/4 of Section 1-1-16,  
recorded as N87°22'20"E in the Wisconsin State Plane Coordinate System,  
South Zone, (NAD-27).

Coordinates are referenced to the Wisconsin State  
Plane Coordinate System, South Zone, (NAD-27).

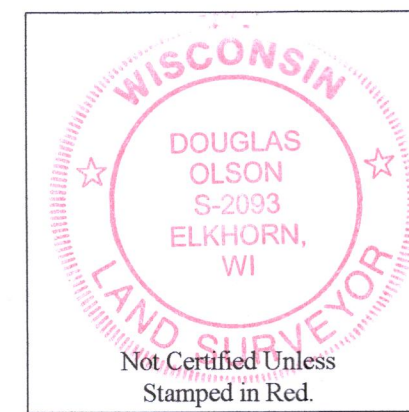

### Notes:

- 1) This Plat of Survey is not certified unless signed and sealed in red ink.
- 2) This survey is subject to Wisconsin lien laws. This Plat of Survey is the notice of intent to file lien. Lien waiver required.
- 3) The Survey Date shown on this Plat of Survey is the completion date of the field work.

Copyright ©2021 by Olson Land Surveying, LLC.

All rights reserved. No part of this survey plat may be reproduced or transmitted in any form by any means - graphic, electronic, or mechanical, including photocopying, tracing, or information storage and retrieval systems - without permission in writing from Douglas G. Olson, Olson Land Surveying, LLC.

I hereby certify that I have surveyed the above described property in compliance with Chapter A-E 7 of the Wisconsin Administrative Code and that the map hereon is correct to the best of my professional knowledge and belief and shows the size and location of the property, its exterior boundaries, the location and dimensions of all visible structures thereon, boundary fences, apparent easements and roadways and visible encroachments, if any.

This survey is made for the exclusive use of the present owners of the property, and also those who purchase, mortgage or guarantee title thereto, within one year from the date hereof.

Douglas G. Olson  
Wisconsin Professional Land Surveyor - 2093

Survey Date: May 17, 2021.  
Revisions:

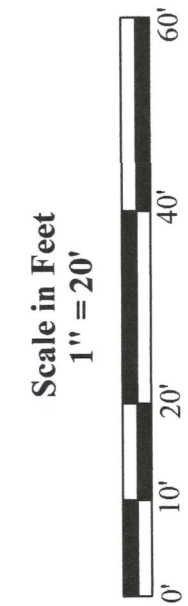

45 South Wisconsin Street | P.O. Box 322  
Elkhorn, Wisconsin. 53121  
Telephone: (262) 723-3434  
Facsimile: (262) 723-8044  
Email: doug@olsonsurveying.com  
Website: www.olsonsurveying.com



Legend of Symbols & Abbreviations	
N	North
S	South
E	East
W	West
In	Inches
Bearings	Bearings
Utilities	Utilities
Distances	Distances
Seconds	Seconds
Minutes	Minutes
Feet	Feet
Concrete	Concrete
Gravel	Gravel
Surface	Surface

Sheet 1 of 1 Sheets	Drawing Name:
Job Reference Number	2021.026

2021.026